

luma

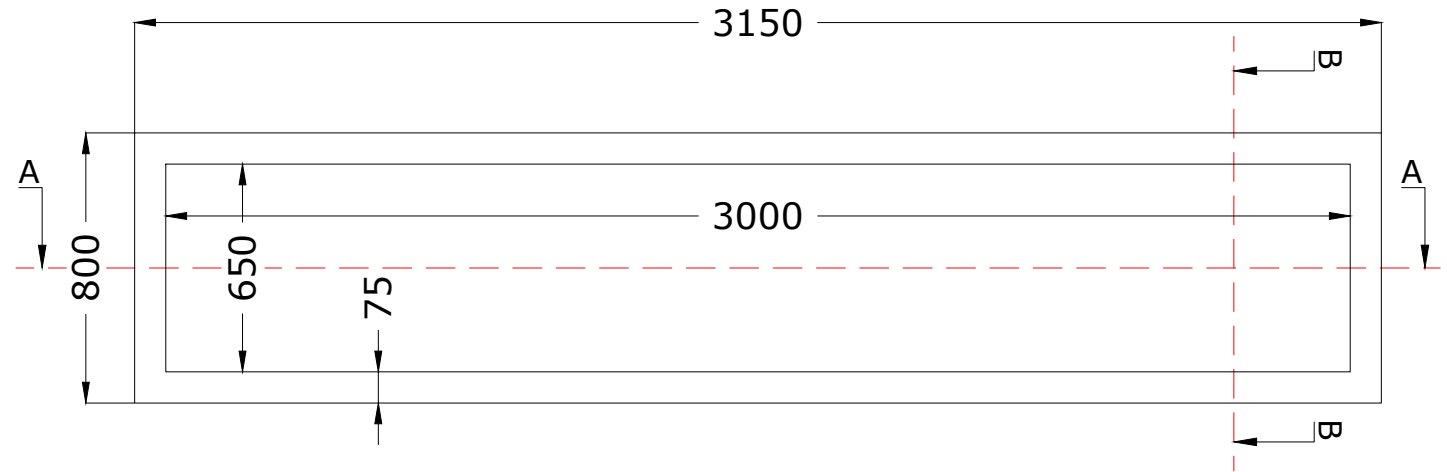

SECTION A-A

LENGTH = 3000 (INTERNAL UPSTAND)

LENGTH = 3150 (EXTERNAL UPSTAND)

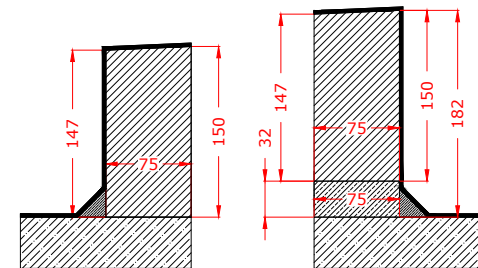
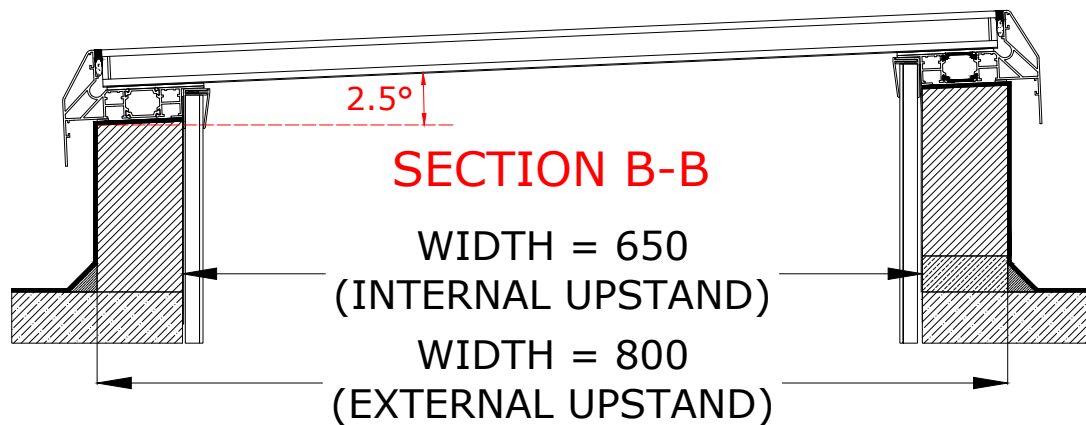

The Luma flat roof light timber upstand requires a 2.5° pitch built into it, to fall down the width (shortest size). Timber sizes as above shows how to create using 75x150 stock size timbers.